

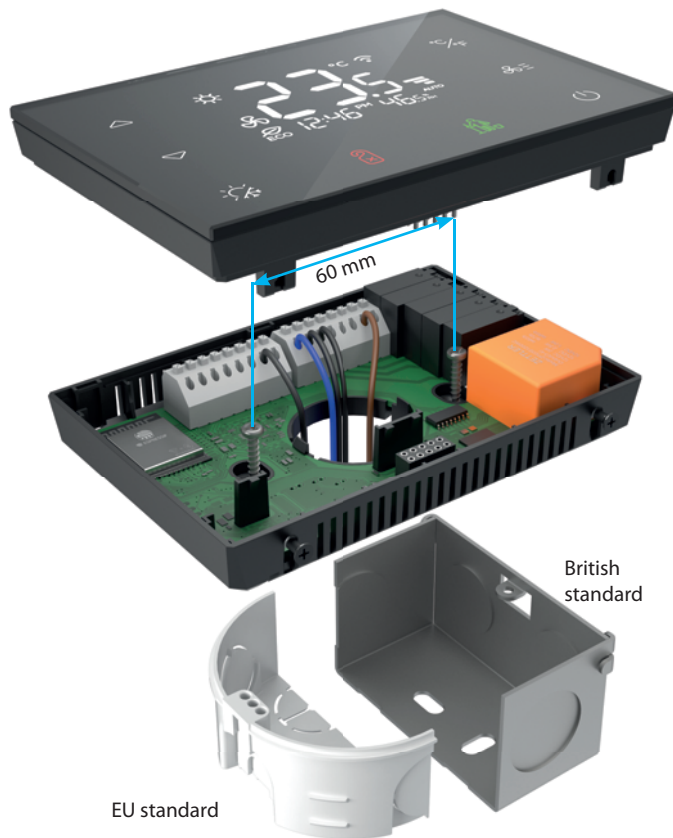

The picture of device is illustrative, the icons (symbols) are configurable by the customer.

- Designed to control 2 and 4 pipe fan coils, chillers
- 3x relays for fan speed (LOW, MEDIUM, HIGH), 2x relays for heating/cooling mode
- 2x analog outputs 0-10V for proportional control of valves
- 2x inputs for connecting wired detectors (door's magnet detector); of which
- 1x input for external temperature sensor TC/TZ
- Built-in digital temperature and humidity sensor
- Proximity sensor to activate display backlight / buttons
- VA/TN LCD display, 8 touch backlit buttons
- Screwless angle clamps for easy wire connection
- WiFi for device setup (via web browser) and connection to iNELS.Cloud, iNELS APP, HRS and BMS via MQTT protocol
- Modbus RTU for external HVAC devices and supervision software
- Power supply: AC 110 – 230V AC
- Installation on round (EU) and square (BS) boxes
- Possibility of the glass and icons customization icons.inels.com

Technical parameters	RFTC-3/W	RFTC-3/B
Power supply		
Power supply voltage:	110 - 230V AC, 50-60Hz, L and N terminals	
Apparent/loss power input:	4 VA/2 W	
Supply voltage tolerance:	± 10%	
Outputs		
Relays:	5x switching / 5A / 250V AC1 / 1385VA	
Contact life:	mechanical: 10 mil. / electrical 100.000 switches	
Analog Output:	2x 0-10V, 10 mA	
Inputs (external)		
Binary:	ro potential-free contact, terminals IN1/IN2 against GND, maximum wire length 30m	
Temperature:	1x for external temperature sensor TC/TZ, terminals IN1/T & IN2/TC, temperature range -20 to +120 °C, accuracy ± 0.5 °C	
Sensors (internal)		
Temperature:	range 0 to +55 °C, accuracy ± 0.5 °C from the range	
Humidity:	0 - 99% RH, accuracy ± 3 °C from the range	
Proximity:	backlight activation when zooming <25 cm	
Lighting:	adaptive backlight control of the display and buttons	
Communications		
Radio:	iNELS RFIO2, frequency 866-922 Mhz	
WiFi:	AP 2.4 Ghz	
Modbus:	RTU 485	
Control and display		
Display:	LCD (VA/TN), active area 54x34mm	
Buttons:	8x, capacitive, backlit	
Functions		
Fancoil types:	2-pipe, 4-pipe	
Parameter settings:	via WiFi and web interface	
Connection		
Terminal block:	16 pole, screwless (push-in)	
Wire cross section:	0.2 - 1.5 mm ² solid / flexible	
Mechanics		
Operating temperature:	- 0 to 50 °C / max 80% RH	
Storage Temperature:	- 20 to 60 °C	
Enclosure:	IP30 (mounted)	
Overvoltage Category:	II.	
Pollution Degree:	2	
Working position:	horizontal	
Installation:	on EU/BS box with 60 mm screw pitch	
Dimension:	120x80x27 mm	
Weight:	230g	
Shape:	SHARP edges	
Color (glass and plastic):	White	Black
Order Code:	8915	8914
EAN Code:	8595188189156	8595188189149
Standard:	EN 60730, EN 63044, EN 301489	



External temperature sensors:

	TC-0	TC-3	TC-6	TC-12
Length:	100 mm	3 m	6 m	12 m
Order code:	209970800010	209970800011	209970800012	209970800013



- Thermister: NTC 12K
- Protection: IP67
- Cable: 2 x 0.25 mm²
- Ending: cavity

Buttons description



Display description

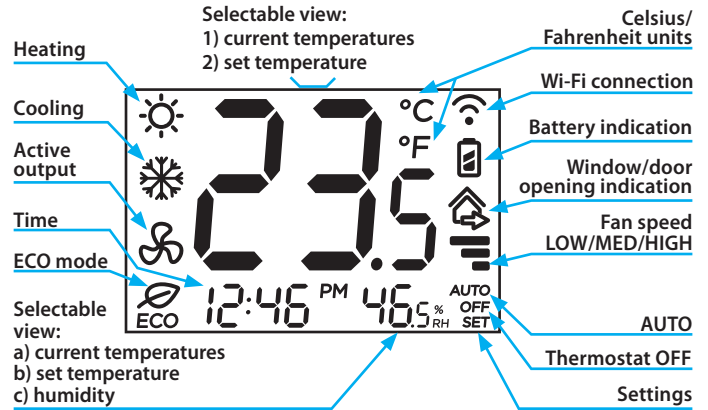

Connection

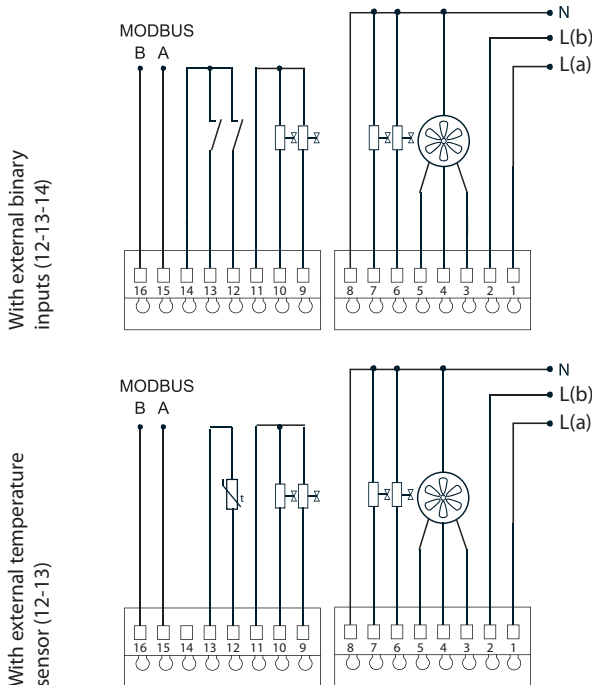

Web configuration

Wi-Fi SSID : RFTC-3_product number IP address: 192.168.1.1

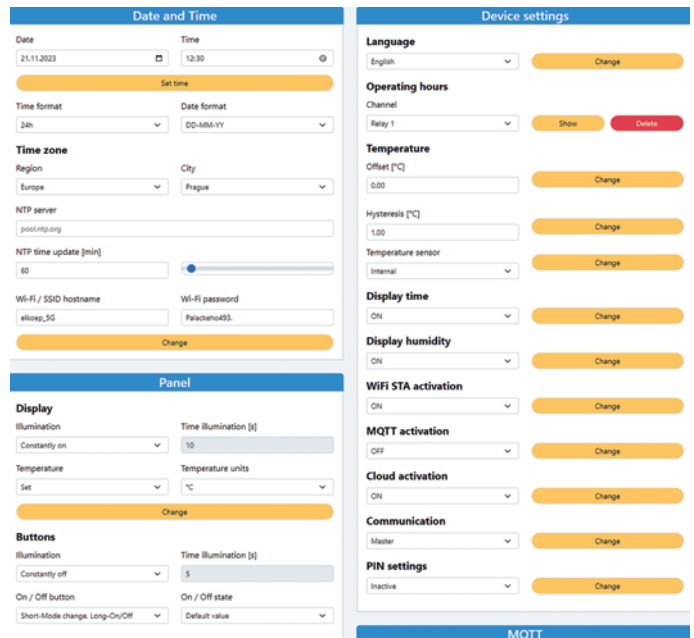

Clamp description

- 1. L(a) power supply phase wire
- 2. L(b) phase - identical to phase L(a) - see. *
- 3. HIGH fan top speed
- 4. MED fan medium speed
- 5. LOW fan lowest speed
- 6. HEAT valve 0/1 for heating
- 7. COOL valve 0/1 for cooling
- 8. N neutral wire power supply
- 9. 1:0-10V 1. analog output 0-10V
- 10. 2:0-10V 2. analog output 0-10V
- 11. GND common terminal for analog output
- 12. IN1 1. binary input for external contact
- 13. IN2 2. binary input for external contact
- 14. COM common terminal for binary inputs 1. and 2.
- 15. BUS A Modbus A
- 16. BUS B Modbus B

Option for an external temperature sensor TC/TZ

- 12. IN1 temperature input NTC
- 13. IN2 temperature input NTC

* in the case of an auxiliary heater, it is connected to terminals 6 or 7 (max. 1500 W).

Variants



BLACK
RFTC-3/B
Order code: 8914
EAN: 8595188189149

WHITE
RFTC-3/W
Order code: 8915
EAN: 8595188189156